



STATE OF MAINE  
DEPARTMENT OF AGRICULTURE, CONSERVATION & FORESTRY  
BUREAU OF PARKS & LANDS  
22 STATE HOUSE STATION  
AUGUSTA, MAINE 04333

JANET T. MILLS  
GOVERNOR

AMANDA E. BEAL  
COMMISSIONER

## NOTICE – August 11, 2022

**Applicant:** Consolidated Communications of Northern New England Company

**Proposal:** To lay a new 4,200 ft. fiber optic cable and maintain two existing submerged utility cables that each extend approximately 3,700 ft. on submerged lands between Castine and Brooksville for utility purposes.

**Location:** Wasson Wharf Road, Bagaduce River, Town of Brooksville

The Bureau of Parks and Lands (Bureau) has received an application to occupy submerged lands for the project described above. Pursuant to Title 12 M.R.S.A., Section 1801 & 1862, the Bureau serves as trustee of submerged lands for the State of Maine. Submerged lands include all land from the mean **low-water** mark seaward to the 3-mile territorial limit including all land below the mean **low-water** mark of tidal rivers upstream to the farthest natural reaches of the tides.

Before the proposal may take place, the applicant must obtain a lease or easement from the Bureau. A lease or easement may be granted for the project if it will not:

- unreasonably interfere with customary or traditional public access ways to, or public trust rights (fishing, fowling, recreation, and navigation) in, on or over the submerged lands;
- unreasonably interfere with fishing or other existing marine uses of the area;
- unreasonably diminish the availability of services and facilities necessary for commercial marine activities; and
- unreasonably interfere with ingress and egress of riparian owners.

A copy of the site plan is attached for information. Any interested party or anyone who is knowledgeable about the area is welcome to comment on possible impacts to the activities listed above. **Comments must be received on or before September 11, 2022.**

For more information, please contact Karen Foust, Bureau of Parks and Lands.

Phone: (207) 287-6128 Fax: (207) 287-6170

Email: [Karen.L.Foust@maine.gov](mailto:Karen.L.Foust@maine.gov)

[www.maine.gov/dacf/submergedlands](http://www.maine.gov/dacf/submergedlands)

cc: Department of Marine Resources

**Please note that all comments received are part of the public record and subject to the State of Maine Freedom of Access laws.**

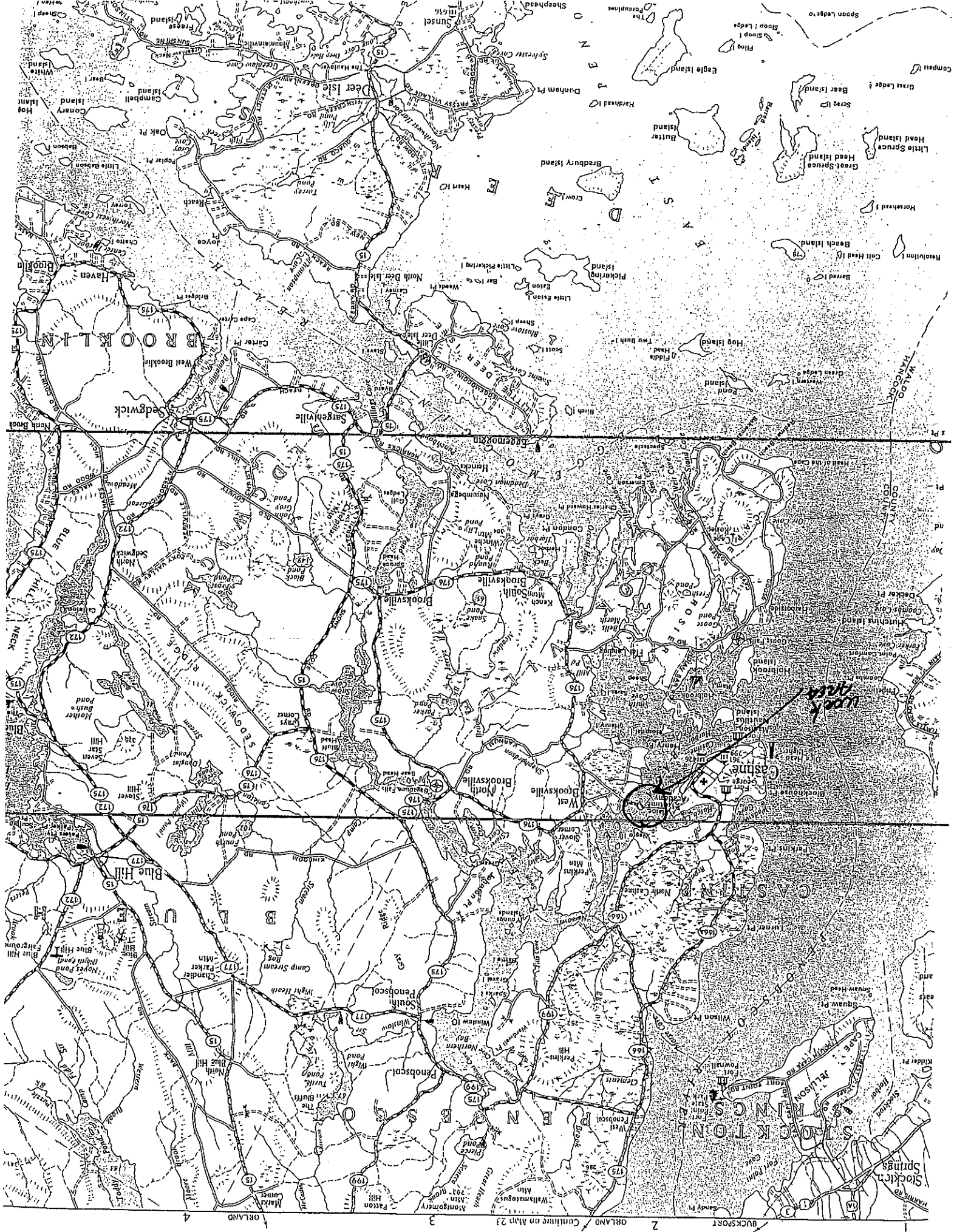

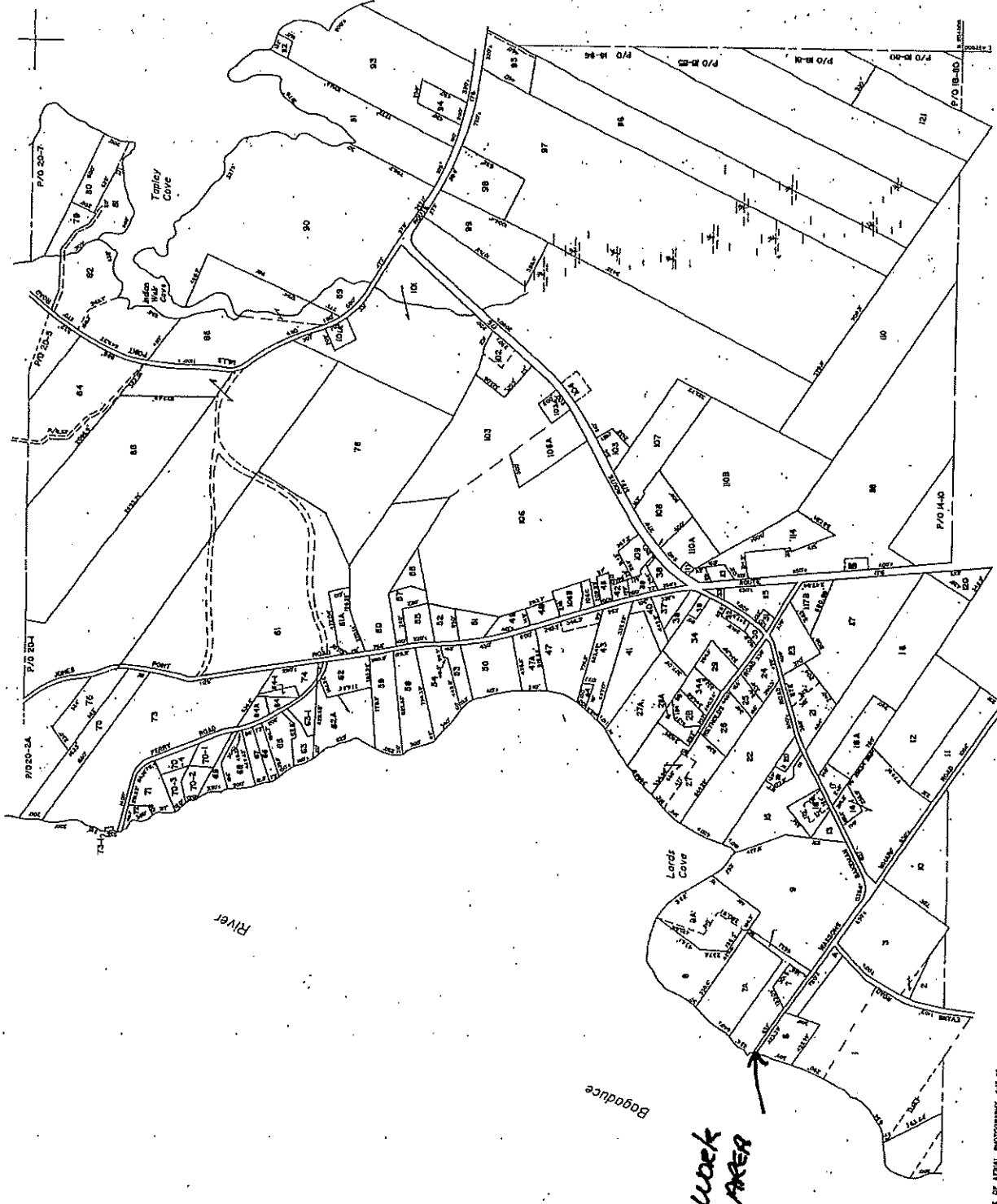

20	18
17	16
TAX MAP NUMBER	

TAX MAP  
**TOWN OF BROOKSVILLE**  
 HENNOCK COUNTY, MAINE  
 JAMES W. SEWALL COMPANY, OLD TOWN, MAINE  
 SCALE: 1 INCH = 400 FEET

DATE OF AERIAL PHOTOGRAPHY \_\_\_\_\_  
 DATE OF COMPLETION \_\_\_\_\_  
 DATE OF RETURN \_\_\_\_\_  
 For Assessment Purpose  
 Not to be used for Contingency

LEGEND  
 PARCEL NUMBERS .....  
 MATCH LINE .....



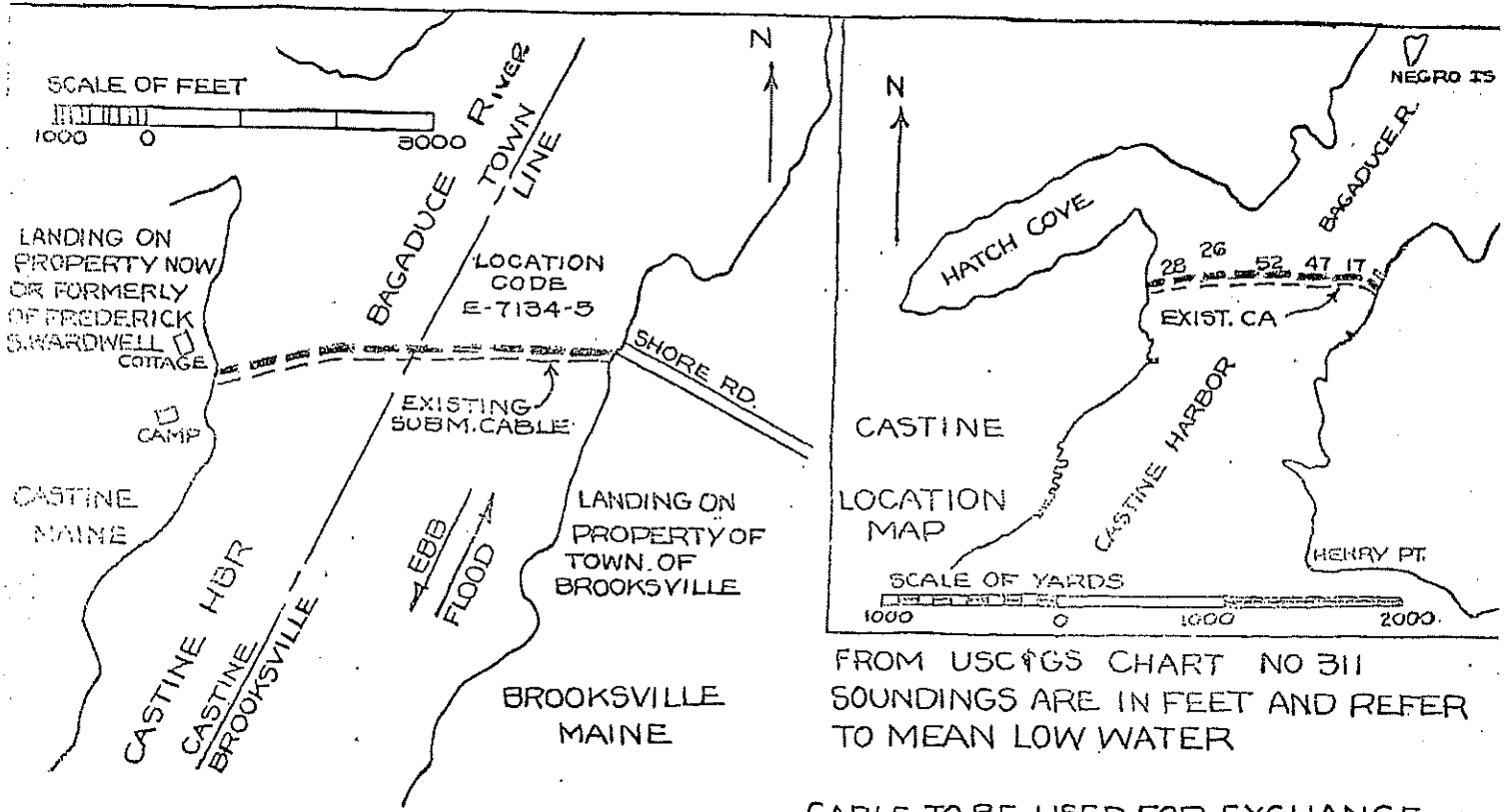

FROM USC & GS CHART NO 311  
SOUNDINGS ARE IN FEET AND REFER  
TO MEAN LOW WATER

CABLE TO BE USED FOR EXCHANGE  
CIRCUIT FACILITIES

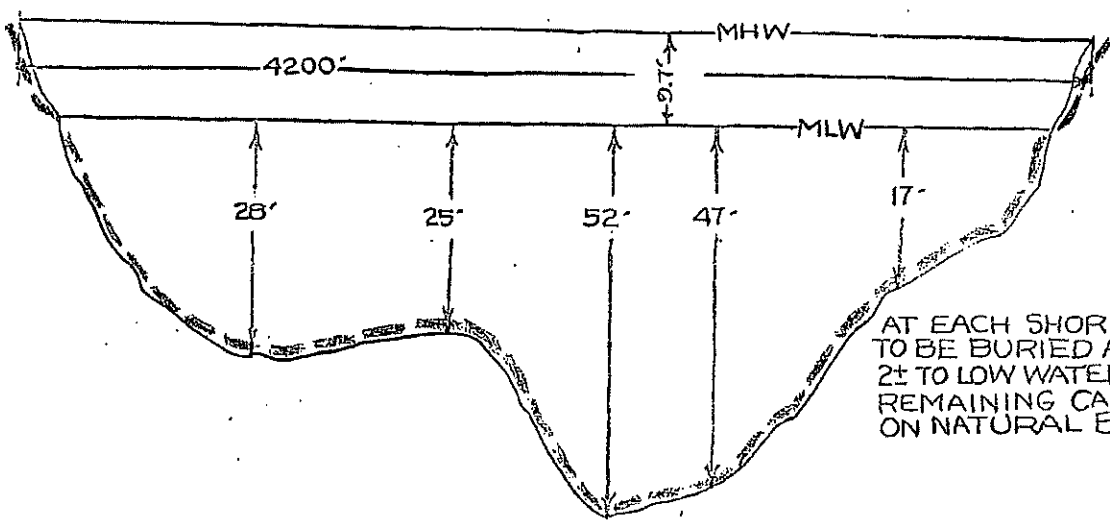

AT EACH SHORE END, CABLE  
TO BE BURIED AT DEPTH OF  
2' TO LOW WATER MARK.  
REMAINING CABLE TO LAY  
ON NATURAL BOTTOM

DOUBLE ARMORED  
SUBMARINE CABLE

SECTION  
SCALES OF FEET

HORIZONTAL

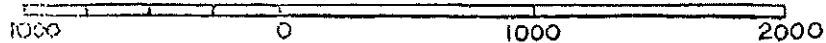

VERTICAL

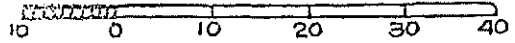

PROPOSED SUBMARINE CABLE  
ACROSS BAGADUCE RIVER  
BETWEEN BROOKSVILLE &  
CASTINE, COUNTY OF HANCOCK  
STATE OF MAINE

July 2022